

**Schedule 12
Part A**

Regulation 33,34

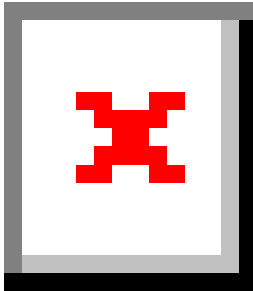

Woking Borough Council

*Civic Offices, Gloucester Square, Woking, Surrey,
GU21 6YL*

Premises licence number

23/00169/PREMIS

Part 1 – Premises details

Postal address of premises, or if none, ordnance survey map reference or description, (including Post Town and Post Code)

Crown Public House

The Crown Public House, 33 High Street, Knaphill, Woking, Surrey, GU21 2PP

Telephone number

01483 480511

The date the licence takes effect

14 July 2023

Licensable activities authorised by the licence and the times the licence authorises the carrying out of licensable activities

Sale of alcohol	Monday to Thursday	11:00 - 23:00
Sale of alcohol	Friday and Saturday	11:00 - 23:30
Sale of alcohol	Sunday	11:00 - 23:00
Dance	Monday to Thursday	09:00 - 23:30
Dance	Friday and Saturday	09:00 - 00:00
Dance	Sunday	09:00 - 23:30
Film	Monday to Thursday	09:00 - 23:30
Film	Friday and Saturday	09:00 - 00:00
Film	Sunday	09:00 - 23:30
Late Night Refreshment	Friday and Saturday	23:00 - 23:30

PREMIS

Live music	Monday to Thursday	09:00 - 23:30
Live music	Friday and Saturday	09:00 - 00:00
Live music	Sunday	09:00 - 23:30
Recorded music	Monday to Thursday	09:00 - 23:30
Recorded music	Friday and Saturday	09:00 - 00:00
Recorded music	Sunday	09:00 - 23:30
Indoor sport	Monday to Thursday	11:00 - 23:00
Indoor sport	Friday and Saturday	11:00 - 23:30
Indoor sport	Sunday	11:00 - 23:00

Seasonal variation / non-standard timings:

The Licensable Activities will be permitted outside of the hours specified when a major sporting event is to be shown on television in the premises and where the following apply:-

- i. A minimum of 10 days notice is given to the Police
- ii. The Premises Licence Holder or DPS receives agreement in writing from the Police Licensing Officer to the premises opening and selling alcohol
- iii. The major sporting event is either:-
 - An International Football match featuring England, Scotland, Ireland, Wales or Northern Ireland.
 - An International Rugby Union match featuring England, Scotland, Ireland, Wales or the British Lions.
 - An International Cricket match featuring England.
 - A Boxing World Title Fight.
 - A Formula One Race.

The opening hours of the premises

Opening hours	Monday to Thursday	09:00 - 23:30
Opening hours	Friday and Saturday	09:00 - 00:00
Opening hours	Sunday	09:00 - 23:30

Seasonal variation / non-standard timings:

The Licensable Activities will be permitted outside of the hours specified when a major sporting event is to be shown on television in the premises and where the following apply:-

- i. A minimum of 10 days notice is given to the Police
- ii. The Premises Licence Holder or DPS receives agreement in writing from the Police Licensing Officer to the premises opening and selling alcohol
- iii. The major sporting event is either:-
 - An International Football match featuring England, Scotland, Ireland, Wales or Northern Ireland.
 - An International Rugby Union match featuring England, Scotland, Ireland, Wales or the British Lions.
 - An International Cricket match featuring England.
 - A Boxing World Title Fight.

- A Formula One Race.

Where the licence authorises supplies of alcohol whether these are on and/or off supplies

Licensed for sales of Alcohol both on and off premises

Performance of Dance, Showing of Films, Live Music, Recorded Music are all for indoors only.

Part 2

Name, (registered) address, telephone number and email (where relevant) of holder of premises licence

Craft Union Pub Company Ltd

3 Monkspath Hall Road, Shirley, Solihull, B90 4SJ

E-mail mandy_mighty@gosschalks.co.uk

Registered number of holder, for example company number, charity number (where applicable)

Registered business number 09429990

Name, address and telephone number of designated premises supervisor where the premises licence authorises for the supply of alcohol

Mr Jorgen McMillan

██

Personal licence number and issuing authority of personal licence held by designated premises supervisor where the premises licence authorises for the supply of alcohol

Personal Licence ████████████████████

Licensing Authority Portsmouth City Council

1 August 2023

Date Licence Issued



Senior Licensing Officer

Annex 1 – Mandatory conditions

- 1) No supply of alcohol may be made under the premises licence
 - (1) At a time when there is no Designated Premises Supervisor in respect of the premises licence, or
 - (2) At a time when the Designated Premises Supervisor does not hold a personal licence or his personal licence is suspended.
- 2) Every retail sale or supply of alcohol made under this licence must be made or authorised by a person who holds a personal licence.
- 3) (1) The responsible person must ensure that staff on relevant premises do not carry out, arrange or participate in any irresponsible promotions in relation to the premises.

(2) In this paragraph, an irresponsible promotion means any one or more of the following activities, or substantially similar activities, carried on for the purpose of encouraging the sale or supply of alcohol for consumption on the premises.

 - (1) games or other activities which require or encourage, or are designed to require or encourage, individuals to–
 - i. drink a quantity of alcohol within a time limit (other than to drink alcohol sold or supplied on the premises before the cessation of the period in which the responsible person is authorised to sell or supply alcohol), or
 - ii. drink as much alcohol as possible (whether within a time limit or otherwise);
 - (2) Provision of unlimited or unspecified quantities of alcohol free or for a fixed or discounted fee to the public or to a group defined by a particular characteristic in a manner which carries significant risk of undermining a licensing objective.
 - (3) Provision of free or discounted alcohol or any other thing as a prize to encourage or reward the purchase and consumption of alcohol over a period of 24 hours or less in a manner which carries significant risk of undermining a licensing objective.
 - (4) selling or supplying alcohol in association with promotional posters or flyers on, or in the vicinity of, the premises which can reasonably be considered to condone, encourage or glamorise anti-social behaviour or to refer to the effects of drunkenness in any favourable manner.
 - (5) Dispensing alcohol directly by one person into the mouth of another (other than where that other person is unable to drink without assistance by reason of disability).
- 4) The responsible person must ensure that free potable water is provided on request to customers where it reasonably available.
- 5) (1) The premises licence holder or club premises certificate holder must ensure that an age verification policy is adopted in respect of the premises in relation to the sale or supply of alcohol.

(2) The designated premises supervisor in relation to the premises licences must ensure that the supply of alcohol at the premises is carried on in accordance with the age verification policy.

(3) The policy must require individuals who appear to the responsible person to be under 18 years of age (or such older age as may be specified in the policy) to produce on request, before being served alcohol, identification bearing their photograph, date of birth and either:-

 - a. a holographic mark or
 - b. an ultraviolet feature.
- 6) The responsible person shall ensure that–
 - (1) where any of the following alcoholic drinks is sold or supplied for consumption on the premises (other than alcoholic drinks sold or supplied having been made up in advance ready for sale or supply in a securely closed container) it is available to customers in the following measures–
 - a. beer or cider: 1/2 pint;
 - b. gin, rum, vodka or whisky: 25 ml or 35 ml; and

- c. still wine in a glass: 125 ml; and
- (2) These measures are displayed in a menu, price list or other printed material which is available to customers on the premises; and
- (3) where a customer does not in relation to a sale of alcohol specify the quantity of alcohol to be sold, the customer is made aware that these measures are available.
- 7) (1) A relevant person shall ensure that no alcohol is sold or supplied for consumption on or off the premises for a price which is less than the permitted price.
- (2) For the purpose of the condition set out in paragraph 1:-
- (a) “duty” is to be construed in accordance with the Alcoholic Liquor Duties Act 1979
- (b) “permitted price” is the price found by applying the formula:- $P = D + (D \times V)$ where:
- (i) P is the permitted price,
- (ii) D is the amount of duty chargeable in relation to the alcohol as if the duty were charged on the date of the sale or supply of the alcohol, and
- (iii) V is the rate of value added tax chargeable in relation to the alcohol as if the value added tax were charged on the date of the sale or supply of the alcohol;
- (c) “relevant person” means, in relation to premises in respect of which there is in force a premises licence:-
- (i) the holder of the premises licence
- (ii) the designated premises supervisor (if any) in respect of such a licence, or
- (iii) the personal licence holder who makes or authorises a supply of alcohol under such a licence;
- (d) “relevant person” means, in relation to premises in respect of which there is in force a club premises certificate, any member or officer of the club present on the premises in a capacity which enables the member or officer to prevent the supply in question; and
- (e) “value added tax” means value added tax charged in accordance with the Value Added Tax Act 1994.
- (3) Where the permitted price given by Paragraph (b) of paragraph (2) would (apart from this paragraph) not be a whole number of pennies, the price given by that sub-paragraph shall be taken to be the price actually given by that sub-paragraph rounded up to the nearest penny.
- (4) (a) Sub-paragraph (2) applies where the permitted price given by Paragraph (b) of paragraph (2) on a day (“the first day”) would be different from the permitted price on the next day (“the second day”) as a result of a change to the rate of duty or value added tax.
- (b) The permitted price which would apply on the first day applies to sales or supplies of alcohol which take place before the expiry of the period of 14 days beginning on the second day.

Conditions relating to where the Premises Licence allows Exhibition of Films

- 1) Where a premises licence authorises the exhibition of films, the licence must include a condition requiring the admission of children to the exhibition of any film to be restricted in accordance with this section.
- 2) Where the film classification body is specified in the licence, unless subsection (3)(b) applies, admission of children must be restricted in accordance with any recommendation by that body.
- 3) Where
 - a. the film classification body is not specified in the licence, or
 - b. The relevant licensing authority has notified the holder of the licence that this subsection applies to the film in question,admission of children must be restricted in accordance with any recommendation made by that licensing authority.
- 4) In this section “children” means any person aged under 18; and “film classification body” means the person or persons designated as the authority under Section 4 of the Video Recordings Act 1984(c39) (authority to determine suitability of video works for classification).

Annex 2 – Conditions consistent with the operating schedule

General – all four licensing objectives

- A CCTV system will be installed and maintained at the premises. Images will be retained for a minimum period of 28 days and copies of images made available to officers of the Responsible Authorities on request.
- An incident log shall be kept at the premises and will record following
 - i. All ejections of patrons
 - ii. any complaints received concerning crime and disorder
 - iii. and the incident of disorder
 - iv. any visit by a relevant authority or emergency service
- All staff whose duties include alcohol sales will receive training with regard to the age verification policy in operation and their responsibilities and obligations under Licensing Act 2003. Training records will be retained on site and made available to officers of the responsible authorities on request.

The prevention of crime and disorder

- A refusals register will be maintained detailing all refusals of alcohol sales. That register will be made available to officers of the responsible authorities on request.
- The DPS will have a written policy to deal with all incidents involving illegal drugs. This policy is to be made available on demand by Surrey Police

Public safety

The prevention of public nuisance

- Notices shall be prominently displayed at all exits requesting patrons to respect the needs of local residents and leave the area quietly
- A noise limiting device is to be installed within the premises to control the level of recorded music, to be set in conjunction with the EHO at a level which will not cause nuisance to nearby residential properties
- Gardens and outside areas not to be used for eating or drinking after 2300 hours on all days.
- All doors and windows will be kept closed (save to permit access and egress) whenever regulated entertainment is being operated
- Smoking in the rear garden after 23.00 hours will only be permitted in the existing smoking shelter
- The festoon lighting will be switched off when the garden is not in use
- No amplified live or recorded music or amplified voice such as karaoke will take place outside
- Any television situated in the outside areas of the premises shown on the plan attached to the premises licence will be turned off no later than 2300

The protection of children from harm

- A Challenge 25 age verification policy will be operated. The only acceptable forms of identification are a passport, photocard driving licence, military identification or any other UK/EU government approved form of identification.

Annex 3 – Conditions attached after a hearing by the licensing authority

Not applicable

Annex 4 – Plans

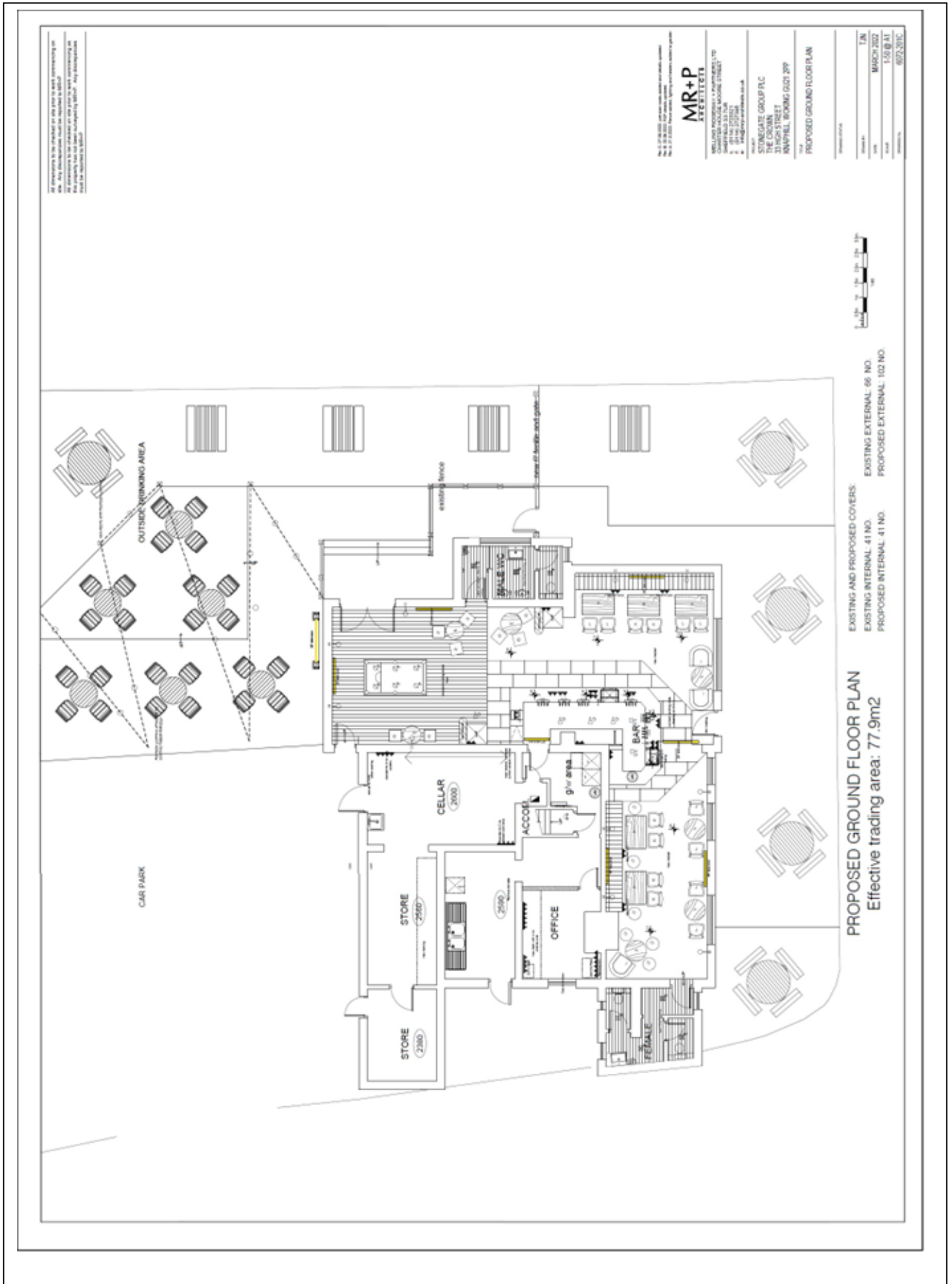

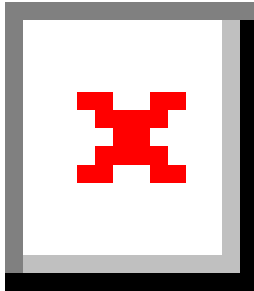

Woking Borough Council
 Civic Offices, Gloucester Square, Woking, Surrey,
 GU21 6YL

Premises licence number

23/00169/PREMIS

Premises details

Postal address of premises, or if none, ordnance survey map reference or description, (including Post Town and Post Code)

Crown Public House

The Crown Public House, 33 High Street, Knaphill, Woking, Surrey, GU21 2PP

Telephone number

01483 480511

The date the licence takes effect

14 July 2023

Licensable activities authorised by the licence and the times the licence authorises the carrying out of licensable activities

Sale of alcohol	Monday to Thursday	11:00 - 23:00
Sale of alcohol	Friday and Saturday	11:00 - 23:30
Sale of alcohol	Sunday	11:00 - 23:00
Dance	Monday to Thursday	09:00 - 23:30
Dance	Friday and Saturday	09:00 - 00:00
Dance	Sunday	09:00 - 23:30
Film	Monday to Thursday	09:00 - 23:30
Film	Friday and Saturday	09:00 - 00:00
Film	Sunday	09:00 - 23:30
Late Night Refreshment	Friday and Saturday	23:00 - 23:30

Live music	Monday to Thursday	09:00 - 23:30
Live music	Friday and Saturday	09:00 - 00:00
Live music	Sunday	09:00 - 23:30
Recorded music	Monday to Thursday	09:00 - 23:30
Recorded music	Friday and Saturday	09:00 - 00:00
Recorded music	Sunday	09:00 - 23:30
Indoor sport	Monday to Thursday	11:00 - 23:00
Indoor sport	Friday and Saturday	11:00 - 23:30
Indoor sport	Sunday	11:00 - 23:00

Seasonal variation / non-standard timings:

The Licensable Activities will be permitted outside of the hours specified when a major sporting event is to be shown on television in the premises and where the following apply:-

- i. A minimum of 10 days notice is given to the Police
- ii. The Premises Licence Holder or DPS receives agreement in writing from the Police Licensing Officer to the premises opening and selling alcohol
- iii. The major sporting event is either:-
 - . An International Football match featuring England, Scotland, Ireland, Wales or Northern Ireland.
 - . An International Rugby Union match featuring England, Scotland, Ireland, Wales or the British Lions.
 - . An International Cricket match featuring England.
 - . A Boxing World Title Fight.
 - . A Formula One Race.

The opening hours of the premises

Opening hours	Monday to Thursday	09:00 - 23:30
Opening hours	Friday and Saturday	09:00 - 00:00
Opening hours	Sunday	09:00 - 23:30

Where the licence authorises supplies of alcohol whether these are on and/or off supplies

Licensed for sales of Alcohol both on and off premises

Performance of Dance, Showing of Films, Live Music, Recorded Music are all for indoors only.

Name, (registered) address of holder of premises licence

Craft Union Pub Company Ltd

3 Monkspath Hall Road, Shirley, Solihull, B90 4SJ

Registered number of holder, for example company number, charity number (where applicable)

Registered business number 09429990

Name of designated premises supervisor where the premises licence authorises for the supply of alcohol

Mr Jorgen McMillan

State whether access to the premises by children is restricted or prohibited

Not Applicable

1 August 2023

Date Licence Issued



Senior Licensing Officer